

# ORNAMENTAL

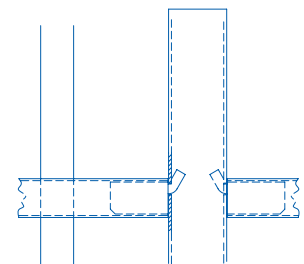

Our Ornamental fencing is designed to provide the aesthetic grace and form of traditional wrought iron railings with the strength and durability of galvanised or galvanised and powder coated steel. Whether in a parkland, corporate HQ or gated community, our Ornamental fencing adds high levels of security to a classical design.

- Custom designs available
- Pale spacing conforms to Building Regulations for anti-trap
- Various mounting options including on wall, inset or free standing
- Posts can be customised for Barbed wire / Razor wire / Rota Spike® / Alarm-aFence®
- 25-year service life guarantee



Post to panel fixings

## APPLICATIONS

- ✓ Perimeters
- ✓ Medium - High risk
- ✓ Residential

## PANELS

Panels have two horizontal rectangular hollow section rails 50 x 25mm; walls 2mm thick. The vertical round hollow section 19mm pales are passed through the rails with standard spacing at 119mm centres and welded into position.

## GATES

Matching gates available

## FINIAL OPTIONS

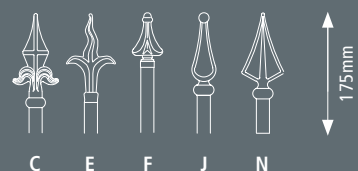

C E F J N

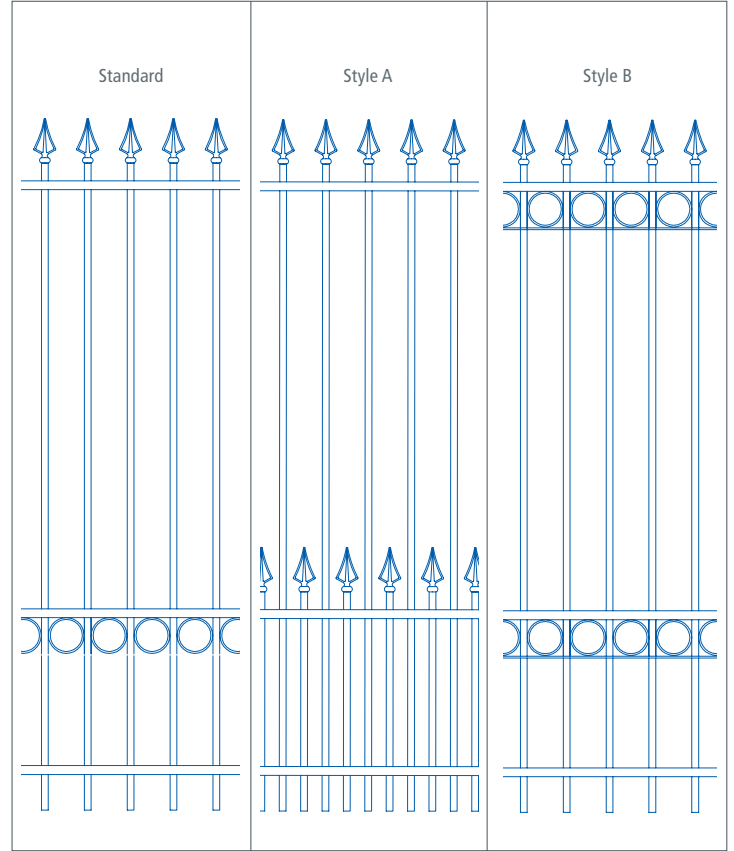

HEIGHT (MM)	POST CENTRES (MM)	POST DIMENSIONS (MM)	OVERALL POST LENGTH (MM)
1000	3000	60 x 60	1600
1200	3000	60 x 60	1800
1500	3000	60 x 60	2100
1800	3000	60 x 60	2500
2000	3000	60 x 60	2800
2500	3000	80 x 60	3300
3000	2400	80 x 60	3800

### POST OPTIONS

- Overlength set in concrete as standard
- Baseplated to bolt down onto concrete
- Cranked to suit wall mounting

### FINISHES

- Hot dip galvanised to BS EN ISO 1461 as standard
- Hot dip galvanised and powder coated to BS EN 13438
- Marine coat for installations within 500m of salt water or an estuary

### STANDARD COLOURS

- Black RAL 9005
- Green RAL 6005
- Other colours are available on request